

Highlights

Commure Care features these valuable capabilities for providers:

- Clinical Results Viewing:** Delivers a complete view of a patient's clinical record on a phone, tablet, or computer, aggregated from multiple clinical systems.
- Secure Messaging:** A secure, real-time communication tool that enables text chat among providers and other users.
- Sign-Out:** Automatically transfers the patient list and all outstanding tasks to the covering provider.
- Clinical Documentation:** Quickly and easily create robust and complete daily progress notes and other encounter documentation on a mobile device or computer.

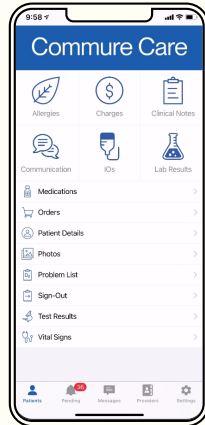

Commure's mobile and desktop solution to streamline providers' clinical workflow.

Commure Care (formerly known as the PatientKeeper Clinical Workflow Solution) is an original Commure application comprising a set of clinical workflow modules designed to make it easier and more efficient for clinicians to access patient information and collaborate with their care team colleagues. Commure Care can be used on mobile devices and web-connected computers, integrates seamlessly with any EHR system already in place, and is bolstered by the highest security standards required in healthcare environments today.

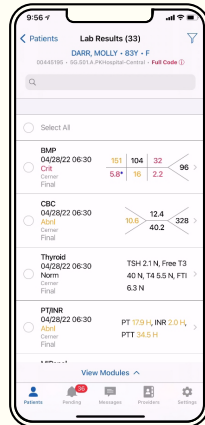

Clinical Results Viewing

Providers can access a comprehensive set of clinical data stored in their hospital's EHR or departmental systems anytime, anywhere, and from any mobile device or web-connected computers. Commure brings all of the patient's clinical data together; no need to sign into multiple computers in multiple locations throughout the day.

Information available through the Clinical Results Viewing module includes:

- Patient list
- Lab and test results
- Medication list
- Clinical notes
- Problem list
- Vital Signs and I/Os
- Allergies
- Order status

Key Features

- Versatile, highly configurable patient list supports a wide variety of workflows.
- HIPAA-compliant messages can be sent to and from third-party applications or systems.
- Embedded e-signature capability.
- Fully integrated with your hospital's EHR system.

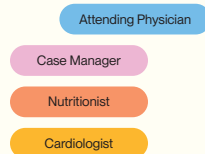
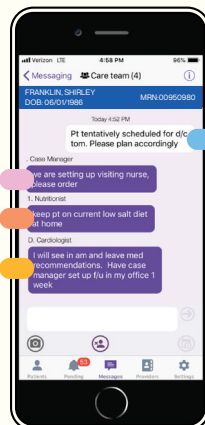

Secure Messaging

Timely communication among members of a care team is critical to delivering exceptional patient care. Since team members are rarely all in the same place, at the same time, it's vital that they can communicate anytime, anywhere. Secure Messaging enables HIPAA-compliant messaging embedded within a provider's workflow with access to the patient's entire electronic medical record.

Oftentimes a text update itself isn't enough to arm care team members. Secure Messaging enables users to include in-context information such as lab results, a photo of a wound that requires consult, or radiology images can save time by eliminating unnecessary back and forth and enable more efficient communication with clinicians who may be offsite. In addition, Commure can be integrated with a hospital's on-call scheduling system to ensure easy access to the appropriate consultant.

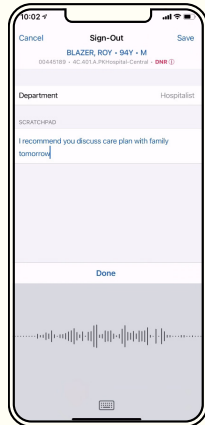

Sign-Out

Sign-Out provides a continuity of care that facilitates faster discharges, enhances patient safety, and aids compliance with Joint Commission patient safety requirements. Providers begin with a manageable summary, including condition updates, code status, problems, pertinent tests and treatments, and to-do items sorted by priority. Covering providers know at a glance how to prioritize patient needs. At shift-end, Sign-Out allows providers to quickly log tasks, patient care details, problems, pertinent tests, and other information that will be needed by covering providers at hand-off.

Sign-Out presents a complete list of all of the tasks a clinician must do to provide quality care to the patient. These can be defined at admission, during rounds, or after a patient encounter. The covering provider knows what to do — whether it's checking admission labs, consulting a cardiologist, ordering a medication, or changing a dressing. Sign-Out ensures faster, more efficient care and eliminates redundant work.

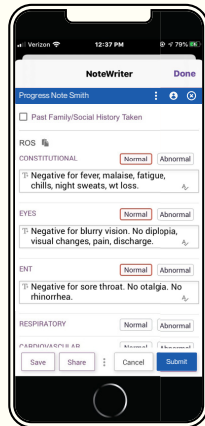

Clinical Documentation

Commure Care enables providers — using just a few taps or clicks — to quickly and easily create robust and complete daily progress notes and other encounter documentation on their mobile device or computer. With Clinical Documentation, providers save valuable time and create easily referenced documentation that can be integrated directly back into the hospital's EHR system of record. Notes are based on customizable templates and can be automatically populated with your patient's demographic and clinical information, including lab results, medications, test results, vital signs, I/Os, and more.

Clinical Documentation time-saving features include:

- **Customized Note Types:** Create customized templates for common notes (such as Progress Notes) that include links to relevant clinical data, enabling physicians to personalize templates as needed.
- **Quick Text:** Save time using menus of previously defined and commonly used words and phrases. Physicians can create Quick Text in advance or while in the process of creating a note.
- **Leverage Yesterday's Note:** Physicians can reuse and edit portions of yesterday's note to facilitate continuity of care and save time documenting subsequent encounters.
- **Integrated Links to Clinical Data:** One of the most powerful features of Clinical Documentation is its ability to import lab results, medications, test results, vital signs, I/Os, and more directly into the note. For example, Clinical Documentation can automatically populate the Objective section of your progress note with the patient's current medications and lab data.
- **Integrated Problem List:** Clinical Documentation helps providers maintain a comprehensive list of current and active problems as a by-product of documentation. As problems are added to a note, they are automatically added to the patient's comprehensive list of problems.